

RESIDENTIAL DRIVEWAY / STORMWATER APPLICATION

APPLICANT'S NAME: _____

ADDRESS: _____ PHONE: _____

CELL PH: _____

LOT: _____ SUBD. & SECTION: _____

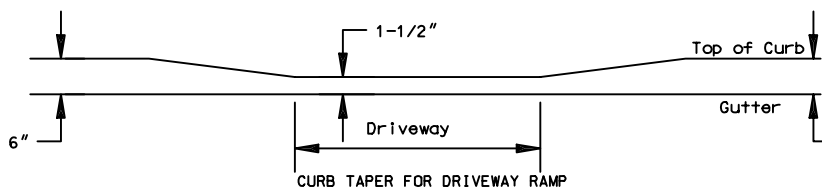
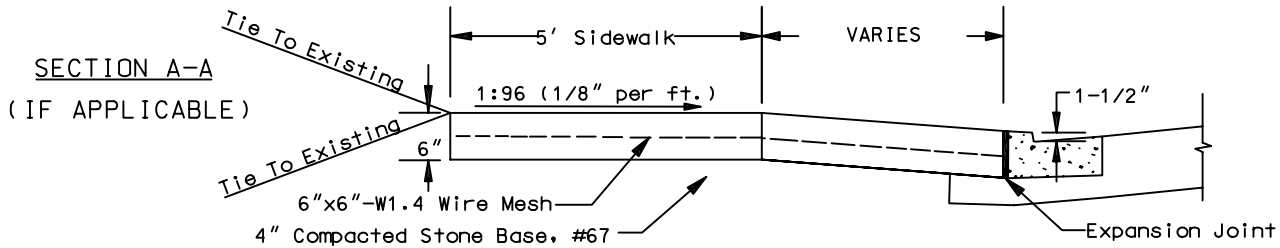
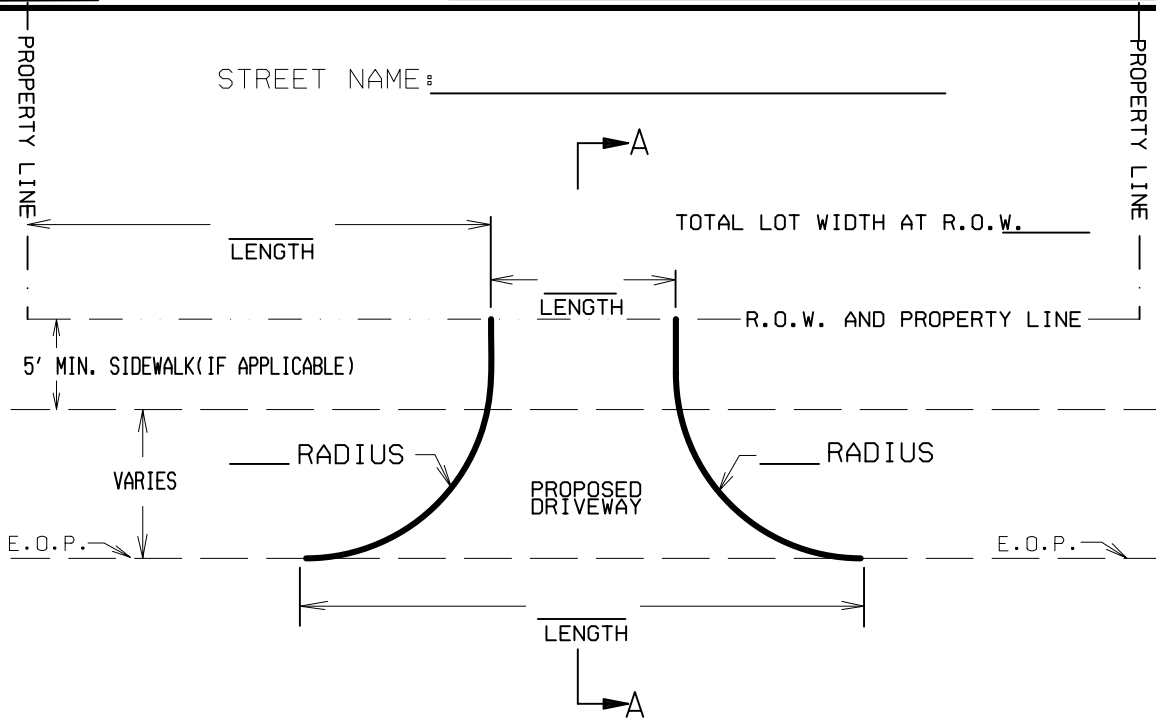

1. CROSS-SLOPE OF SIDEWALK SHALL NOT EXCEED 1:48 (VERTICAL:HORIZONTAL).
2. FIBER MESH REINFORCEMENT IS AN APPROVED ALTERNATIVE FOR THE WIRE MESH. FIBER MESH WILL BE ADDED TO THE CONCRETE AT THE BATCH PLANT AT THE RATE OF 1 1/2 POUNDS PER CUBIC YARD.
3. CURB & GUTTER SHOWN. EXTRUDED CURB ALTERNATE SIMILAR.

1. AT THE TIME OF DRIVEWAY INSPECTION THE PROPERTY CORNER PINS SHALL BE VISIBLE AND THE HOUSE LOCATION STAKED. (THIS IS BEFORE BUILDING PERMIT IS ISSUED.)
2. DRIVEWAY SHALL BE GRADED AND CONSTRUCTED TO PREVENT STORMWATER FROM RUNNING DOWN THE DRIVE FROM THE STREET.
3. DRIVEWAY ELEVATION SHALL BE 1 3/4" ABOVE FINAL EDGE OF PAVEMENT SURFACE.
4. CULVERT SHALL BE SLOPED TO DRAIN WITH EXISTING DITCH (MINIMUM SLOPE OF 0.5%).
5. INDICATE DIRECTION OF FLOW IN DITCH.
6. SEDIMENT BARRIERS SHALL BE INSTALLED AT BASE OF 10% OR GREATER SLOPES OR IN AREAS WHERE SEDIMENT IS LIKELY TO ENTER THE STREET, DRAIN WAYS, OR DEVELOPED PROPERTY.

SIGNATURE: _____ DATE: _____

APPLICANT AGREES TO CONSTRUCT DRIVEWAY IN ACCORDANCE WITH THIS PERMIT.

APPLICATION APPROVED BY: _____
DATE: _____

SET BACKS APPROVED BY: _____
DATE: _____